



Kingfisher Company, inc.

DH SERIES Magnetic Fire Door Holders



Description:

The DH Series Electromagnetic Fire Door Holders are constructed of the finest materials and workmanship available. Each door holder is made of durable die-cast metal and offered in a powder-coated finish.

Installation is easy with DH Series installation technique - an adhesive template assures alignment without secondary adjustments. No brackets are required for recessed, flush or surface mounting (the surface mounting box has three conduit ready entries). Plus, the new catch plate features two pivot points and two way adjustability to further ensure perfect alignment. Optional extension rods are also available for providing the proper gap distance between the door and wall.

The basic units offer superior reliability with built-in transient protection and low residual magnetism so they release easily even on new ADA low pressure door closers.

Features:

- Extremely low current draw. Only 20mA at 24V saves on power supplies and backup batteries.
- New recessed mount for lowest profile look.
- Dual voltage inputs in each units reduces stocking requirements.
- Self-adjusting swivel catch-plate reduces installation time and adjusts to door alignment changes.
- Optional extension rods make installation faster.
- Low residual magnetism easily releases even on new ADA low pressure door closers.
- Built-in transient protection.
- Floor mount units available.

Specifications:

Model	Voltage	DC/mA	AC/mA	Terminals	Holding Force
24120	24V	20	19	C&L	35 lbs. (18.1 kg)
	120V	-	20	C&H	35 lbs. (15.8 kg)

DOOR MAGNET

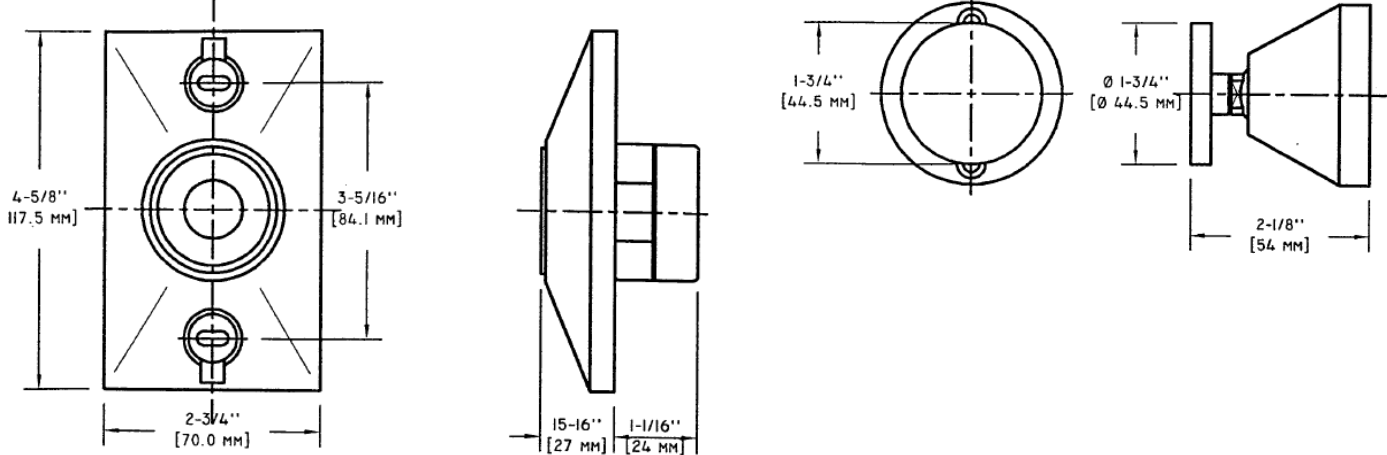

ORDERING INFORMATION

KCi #	Model #	Description
82115	KFDH24120SPC	24V AC/DC, 120 VAC Surface Mount, Electromagnetic Door Holder
82116	KFDH24120FPC	24V AC/DC, 120 VAC Semi-Flush Mount, Electromagnetic Door Holder
82117	KFDH24120RPC	24V AC/DC, 120 VAC Recessed Mount, Electromagnetic Door Holder
82118	KFDH24120GPC	24V AC/DC, 120 VAC Floor Mount Electromagnetic Door Holder, Single Coil
82119	KFDH24120GPC2	24V AC/DC, 120 VAC Floor Mount Electromagnetic Door Holder, Double Coil
82120	KFDHE1PC	1" Extension Rod
82121	KFDHE2PC	2" Extension Rod
82122	KFDHE3PC	3" Extension Rod
82123	KFDHE4APC	4" Adjustable Extension Rod
82124	KFDHSBPC	Swivel Base
82115-DTS		Specification Data Sheet

Kingfisher Company, inc., products must be used within their published specifications and must be PROPERLY specified, applied, installed, operated, maintained and operationally tested in accordance with their installation instructions at the time of installation and at least twice a year or more often and in accordance with local, state and federal codes, regulations and laws. Specification, application, installation, operation, maintenance and testing must be performed by qualified personnel for proper operation in accordance with all of the latest National Fire Protection Association (NFPA), Underwriters' Laboratories (UL), National Electrical Code (NEC), Occupational Safety and Health Administration (OSHA), local, state, county, province, district, federal and other applicable building and fire standards, guidelines, regulations, laws and codes including, but not limited to, all appendices and amendments and the requirements of the local authority having jurisdiction (AHJ).

NOTE: Due to continuous development of our products, specifications and offerings are subject to change without notice in accordance with Kingfisher Company, inc., standard terms and conditions

Kingfisher Company, inc. 81 Old Ferry Road - Lowell, MA 01854
 Phone: 978-596-0214 Fax: 978-596-0217 www.kfci.com